

Tofte Manor Membership



Join us in building a community of like-minded seekers as a Tofte Manor member.

Membership is by approval and will be offered after the application process has been completed. It will only be offered to those dedicated and committed to a spiritual path.

BENEFITS:

- The opportunity to stay at Tofte Manor on a private retreat in our beautiful Sanctuary Cottage and one free yoga, meditation or crystal healing session during your stay.
- The free opportunity to visit Tofte manor on a personal visit without being part of a group event with access to the garden, the grounds, and the Labyrinths.
- Access to regular Members Zoom talks on various inspirational subjects.
- An invitation to the annual summer 'members only' gathering at Tofte Manor.
- Access to the Tofte Manor members directory.
- Star members will receive 5% discount on all retreat bookings.
- Early Bird access to Labyrinth Festival tickets



Map of Tofte Manor Grounds

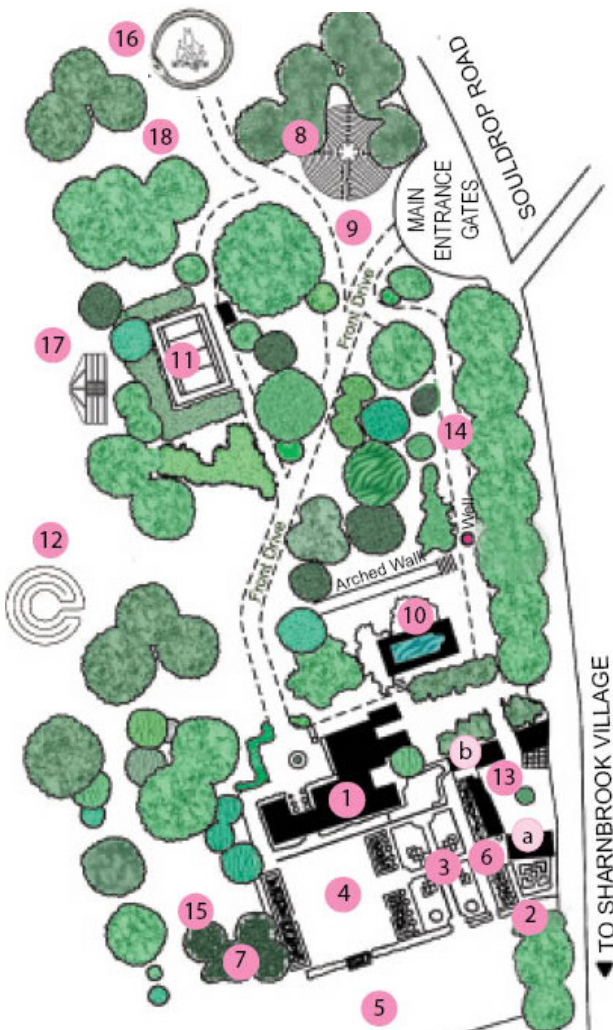

- | | |
|-----------------------|---------------------------|
| 1. House | 11. Tennis Court |
| 2. Parterre Garden | 12. The Earth Labyrinth |
| 3. Sunken Garden | 13. The Stables Courtyard |
| 4. Formal Gardens | a. The Crystal Room |
| 5. Stone Lion | b. Public Loos |
| 6. Sphere Fountain | 14. Car Park |
| 7. Cedar of Lebanon | 15. Hanging Pumpkin |
| 8. Crimean Turkey Oak | 16. Fire Pit |
| 9. Star Labyrinth | 17. Yurt |
| 10. Swimming Pool | 18. The Sanctuary |

The Labyrinth Prayer

As I walk this labyrinth
I ask that my heart
Be fully opened and reconnected
To the love of the earth mother
Beneath my feet
And that my spirit and soul be ignited
In awe of the light of the
Cosmic father above me

May these energies of love an light
Mingle and marry
In my heart,
My consciousness and my whole being
So that through me the cosmic father
And earth mother may reunite
In their blissful, creative dance
Of Sacred Union



For further information please contact
enquiries@toftemanor.co.uk

01234 781924 or 07787 155167

www.toftemanor.co.uk

Tofte Manor, Souldrop Road, Sharnbrook, Bedfordshire MK44 1HH

TOFTE MANOR
Labyrinths
Star & Earth

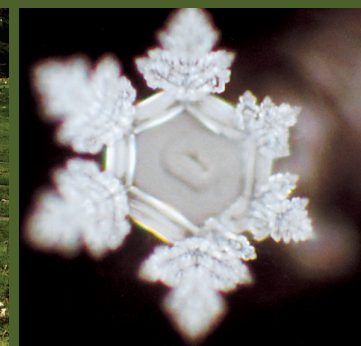
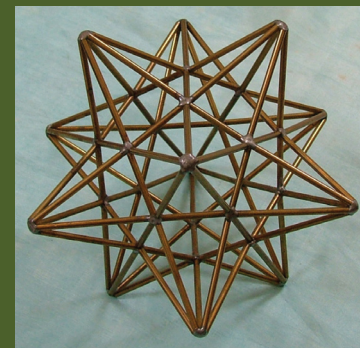

TOFTE MANOR
Labyrinths
Star & Earth



The Star Labyrinth



The Star Labyrinth was conceived with the help and guidance of the Universe and brought into being by Suzy Castleman. It was built by Haywood Landscapes, with input and advice from Jeff Saward and Kimberley Lowell Saward. It was completed in October 2004.

The Star Labyrinth faithfully copies the design of the labyrinth in Chartres

Cathedral in France and is mathematically and proportionally accurate. The design of the Chartres labyrinth has been dated around 1200, during the time of the Crusades. It was used during this period as a prayer tool for those that could not afford to make the journey of pilgrimage to the Holy Land. As time has passed it has come to symbolise our personal journey to the Divine within us and much more.

The Star Labyrinth holds unique qualities, it incorporates all the elements in its design. Earth, Air, Fire and Water. Earth and Air lovingly surround and support us. When there is no naked flame, Fire is represented by the stainless steel mirrored tetrahedrons that surround the site. Water runs in six hundred metres of copper piping below the earth, creating a replica

...blending of spirit with matter...

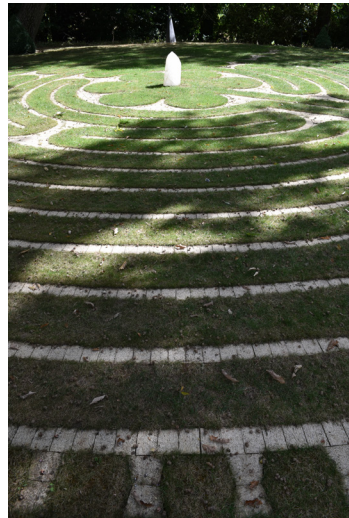

of the labyrinth pattern underground, and can be drunk from the tap at its entrance. A large celestial smoky quartz crystal is buried in the centre of the labyrinth.

The labyrinth has been placed on the Earth in alignment with its magnetic energies on a north-south axis. You enter from the south with north ahead of you, east to your

right and west to your left. In the Native American tradition these directions also represent the elements. The north representing Air, the south Fire, the east Water and the west Earth.

Samples of water entering and leaving the Tofte Labyrinth were sent to the Hado Life Laboratory of Professor Masaru Emoto in Lichtenstein for photographing. Professor Emoto has researched and written many books on water and its energy. He has discovered that good healthy energised water when frozen will always create a star shape based on the hexagon, a snowflake. Through photographing the frozen molecules of water he has been able to examine the shapes that water makes when it is placed in different environments. He has found that polluted, 'dead' or un-energised water forms a chaotic shape with no geometric structure.

The Earth Labyrinth

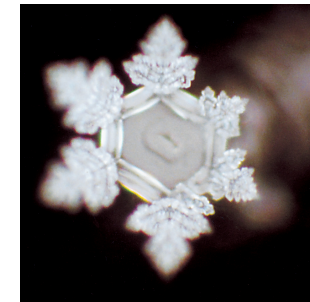
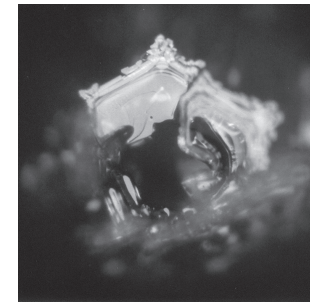

Rising above this unique earth labyrinth sits a bronze sculpture by Domenic Welch, called 'Rising Form', an echo of the earth's calling to us to pay attention. Entering this labyrinth we are challenged to face our fears of darkness and let go, trust and dive into the mystery of the creative matrix. We are invited to have a conversation with Mother Earth and with ourselves.

The Earth Labyrinth is inspired by the sacred geometric form of the vesica piscis or the vulva, the yoni, the sacred entrance into the creatrix of the womb. As you walk to the centre of this seven-circuit labyrinth an underground passageway takes you into an earth chamber which sits in darkness and invites you into the stillness and creative energy of the Mother Earth womb. From darkness all life begins, out of the Void, out of a seed buried underground and out of our wombs.

At the very centre of the dark chamber rests a seat with a large quartz crystal buried underground that your feet sit upon. In the winter a little water rises into the chamber representing the nourishing amniotic fluid of the womb. In the summer it dries up

...love of the Earth Mother



echoing the natural flow of nature's sap, above and below the earth as the seasons change.

These energetic forms connects us to the Light of the Solar Father, the divine creative spark of our Galaxy, and the love of the Earth Mother, the womb that gives this spark life, in a creative stream of Light fused with the Spirit of Love.

It is with this in mind that this labyrinth has been created. Open your hearts and enjoy!

